

8

7

6

5

4

3

2

1

8

7

6

5

4

3

2

1

NOTES:

- 1. ENCLOSURE TYPE:  
WEATHERPROOF, IP66(NEMA 4X), LIGHT GRAY, POLYSTYRENE ENCLOSURE. REMOVEABLE COVER WITH SELF RETAINING SCREWS.
- 2. CABLE GLAND GRIP RANGE: 0.230-0.530 INCHES
- 3. WEIGHT: 1 LB (0.45 Kg)
- 4. SUGGESTED MOUNTING HARDWARE: 8-32 SOCKET HEAD CAP SCREW.  
MOUNTING HOLE ENCLOSURE THICKNESS: 0.188 INCH  
MOUNTING HOLE SCREW HEAD MAX DIAMETER: 0.340 INCH  
MOUNTING HOLES LOCATED UNDER EACH COVER SCREW (4 TOTAL).
- 5. CABLE GLAND CONFIGURATION BASED ON PART NUMBER AS FOLLOWS:  
P/N 03-03000-1 TWO CABLE GLANDS = A & B  
P/N 03-03000-2 THREE CABLE GLANDS = A, B, & C  
P/N 03-03000-3 FOUR CABLE GLANDS = A, B, C, & D  
P/N 03-03000-4 FIVE CABLE GLANDS = A, B, C, D, & E

REVISIONS			
REV	DESCRIPTION	DATE	APPROVED

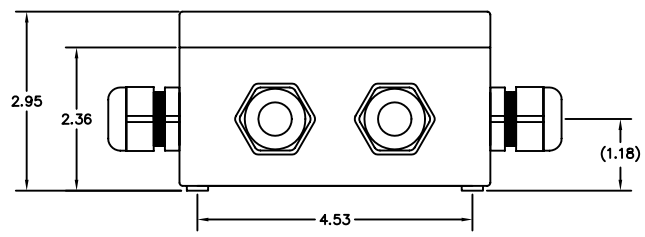
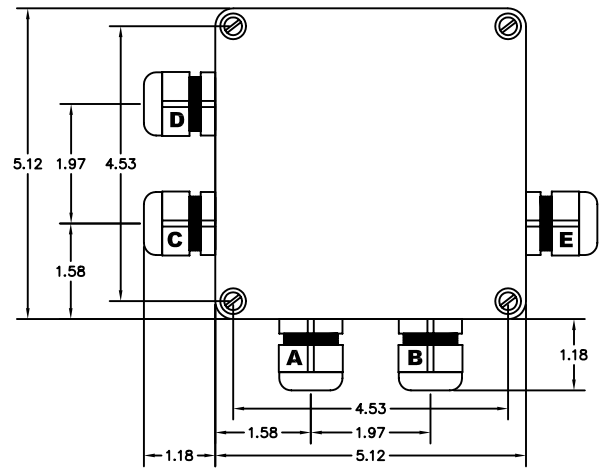

QTY	REV	U of M	PART NUMBER OR IDENTIFYING NUMBER	CAGE CODE	DESCRIPTION

PARTS LIST		 BRAIDSHAW COMMUNICATION SYSTEMS DUNWOODY, GEORGIA
MATERIAL	UNLESS OTHERWISE SPECIFIED ALL DIMENSIONS ARE IN INCHES AND INCLUDE APPLIED FINISH	
FINISH	INTERPRET DRAWING PER ANSI Y14.5M-1994 DRAWN BY: AVE APPD ENG: AVE APPD MFG CHECKED APPD NEXT ASSY: WFC1 USED ON: WFC1	<b>OUTLINE MOUNTING, WFC1</b> SIZE: D CAGE CODE: BCS DRAWING NO.: OMD-WFC1 DWG NO.: OMDWFC1 SCALE: 1=1 SHEET 1 of 1
	TOLERANCES 1 PLACE DECIMALS ±0.1 2 PLACE DECIMALS ±0.03 3 PLACE DECIMALS ±0.005 ANGLES ± HOLE DIAMETERS PER ANSI B3.1 REPEATABILITY NON-CUMULATIVE	
PARENTHERTICAL INFORMATION FOR REFERENCE ONLY.		